

Dimensions (inches)

Pump Model	A	B	C	D
60520	16.94	13.80	18.19	34.01
60527	19.54	16.37	19.50	36.56

For connection sizes/ratings and motor sizes refer to engineering data table on reverse.

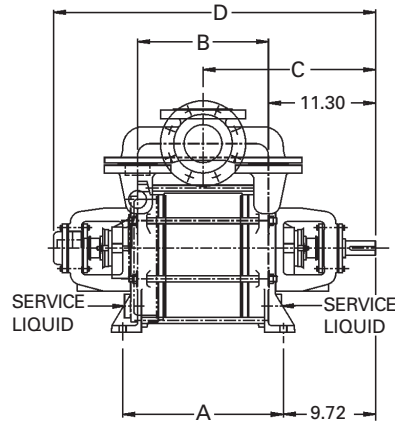
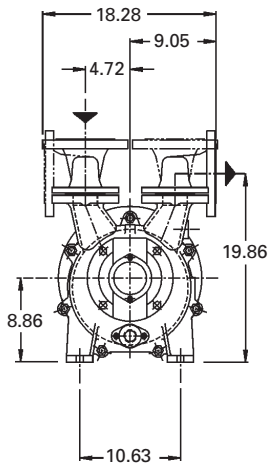

For baseplate mounting, please obtain factory certified dimensions.

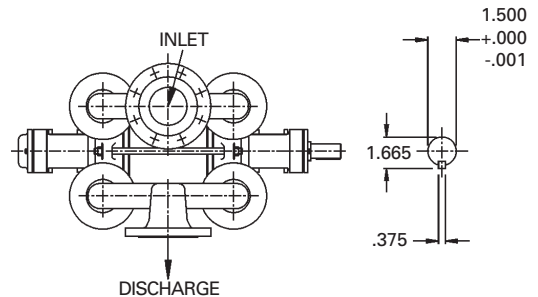

\*Side discharge available in OB pumps only.

Capacity Table

Pump Model - KPH 60520												
Speed (RPM)	2 PSIG		5 PSIG		10 PSIG		15 PSIG		20 PSIG		22 PSIG	
	scfm	HP	scfm	HP	scfm	HP	scfm	HP	scfm	HP	scfm	HP
1750	350	18.0	350	22.0	347	28.0	330	35.0	302	40.0	285	43.0
1450	285	13.0	280	17.0	263	22.0	237	27.0	193	32.0	165	34.0
1150	195	8.0	188	10.0	140	14.0						

Pump Model - KPH 60527												
1750	460	24.0	460	29.0	450	38.0	430	46.0	395	54.0	380	58.0
1450	380	16.0	380	20.0	358	28.0	322	35.0	275	42.0	253	45.0
1150	265	10.0	260	14.0	227	19.0						

This data represents average values for pumps in standard materials. Capacity in cubic feet per minute of free air at 68°F (20°C) using 60°F (16°C) water as a service liquid. Discharge pressure measured at the pump discharge flange.

ENGINEERING DATA

PUMP MODEL	60520	60527
Gas Conn. Size/Rating (U)	4"/150 RF	4"/150 RF
Service Liq. Line Size/Rating (U <sub>b</sub> )	1"/NPT	1"/NPT
Cont. Drain Size/Rating (U <sub>se</sub> )	½"/NPT	½"/NPT
Motor (@ 1750 rpm) HP	50	60
Bare Pump Wt. (lb)	420	490
4 Direct Dr. Basemount (lb)	1310	1560
Min. V-Belt Sheave Dia.	7.9	9.8
T-Separator/Trap Model	Upon Request	Upon Request
Separator Size - Recirc. (Gal.)	60	60
1/2 Norm. Max. Gas Temp. (°F)	212	212
2 Max. Service Liq. Temp. (°F)	176	176
3 Sound Level (dBA)	72	72
Moment of Inertia Wr <sup>2</sup> (lb. ft <sup>2</sup> )	6.41	8.54
Casing Max. WP / Hydro (psi)	30/45	30/45

1. Max. gas temperature with saturated gases.
2. Higher temperatures possible on request.
3. At 3 ft., 1750 RPM w/o motor (not certified).
4. Basemount includes pump, motor, base, coupling and guard.

SERVICE LIQUID RATES (USGPM)

PUMP MODEL - KPH 60520															
Pump Speed	5 PSIG			10 PSIG			15 PSIG			20 PSIG			22 PSIG		
	A	B	C	A	B	C	A	B	C	A	B	C	A	B	C
1750		4.2	3.1		5.8	4.1		7.5	5.3		8.9	6.2		9.6	6.7
1450	6.8	3.8	2.6	9.8	5.2	3.6	12.9	6.7	4.5	15.9	8.0	5.4	17.1	8.6	5.7
1150		2.9	1.9		4.1	2.6									

  

PUMP MODEL - KPH 60527															
Pump Speed	5 PSIG			10 PSIG			15 PSIG			20 PSIG			22 PSIG		
	A	B	C	A	B	C	A	B	C	A	B	C	A	B	C
1750		4.7	3.6		6.9	5.1		8.9	6.5		10.9	7.8		11.8	8.4
1450	6.9	4.1	2.9	10.7	6.1	4.3	14.4	8.0	5.5	18.1	9.8	6.7	19.6	10.6	7.2
1150		3.5	2.3		5.1	3.3									

Column 'A' is the flow in USGPM required - once through.  
 Column 'B' is the make-up flow required when make-up water is 5°C (9°F) cooler than service water.  
 Column 'C' is the make-up flow when make-up water is 10°C (18°F) cooler than service water.  
 For continuous operation, the service liquid supply pressure should be at least the suction pressure, plus 80% of the differential pressure from suction to discharge.

**Note:** The service liquid supply pressure may vary with pump speed and discharge pressure. Please consult factory engineering department for additional information.

SECTIONAL

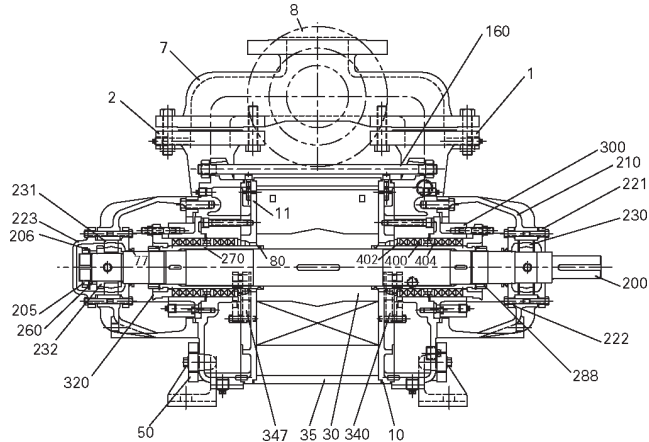

\* Not applicable to LPH 60520

Standard rotation 'AB' (clockwise) viewed from driven end. 'AL' (counter clockwise) upon request.

PARTS LIST

1. Suction Cover	35. Centerbody	206. Lockwasher	232. Bearing Sleeve	347. Orifice Plate Assembly
2. Discharge Cover	50. Counter Flange	210. Bearing Housing	260. Spacer	400. Packing Ring
7. Suction Manifold*	77. Splash Ring	221. Bearing Cover	270. Shaft Sleeve	402. Neck Ring
8. Discharge Manifold*	80. O-ring	222. Bearing Cover	288. Shaft Nut	404. Lantern Ring
10. Intermediate	160. Tie Bolt Assembly	223. Bearing Retainer	300. Packing Flange	
11. Intermediate	200. Shaft	230. Bearing	320. Gland	
30. Impeller	205. Bearing Nut	231. Bearing	340. Orifice Plate Assembly	

\* Both Manifolds vertical up in pumps with 4B materials.

MATERIALS

ITEM	0B	4B
Casing - Wetted	Cast Iron	316 SS
Intermediates	Cast Iron	316 SS
Impeller(s)	Ductile Iron	316 SS
Shaft <sup>5</sup>	420 SS QT <sup>5</sup>	420 SS QT
Shaft Sleeves	420 SS	316 SS
Shaft Sealing	ADB <sup>6</sup>	ADB <sup>6</sup>
Casing-Non Wetted	Cast Iron	Cast Iron

<sup>5</sup>Shaft is a non-wetted part <sup>6</sup>ADB = single o-ring pusher seal with viton o-rings, carbon vs. SiC faces